

## CUSTOMER TECHNICAL MEMO # 262

**Subject** New Outward Opening Escape System

**Date:** 14<sup>th</sup> October 2016

**Author:** Product Development Team

We are always looking at how we can improve our existing products and also design new systems for the ever-evolving marketplace. We are proud to say our design team has been at it again and this time they have re-designed our already impressive Invisi-Scape System.

This system replaces the old Invisi-Scape Outward Opening System and will continue with the name of Invisi-Scape to be consistent with the other Invisi-Scape systems.

This system is in stock in Darwin, Perth and Sydney Branches.

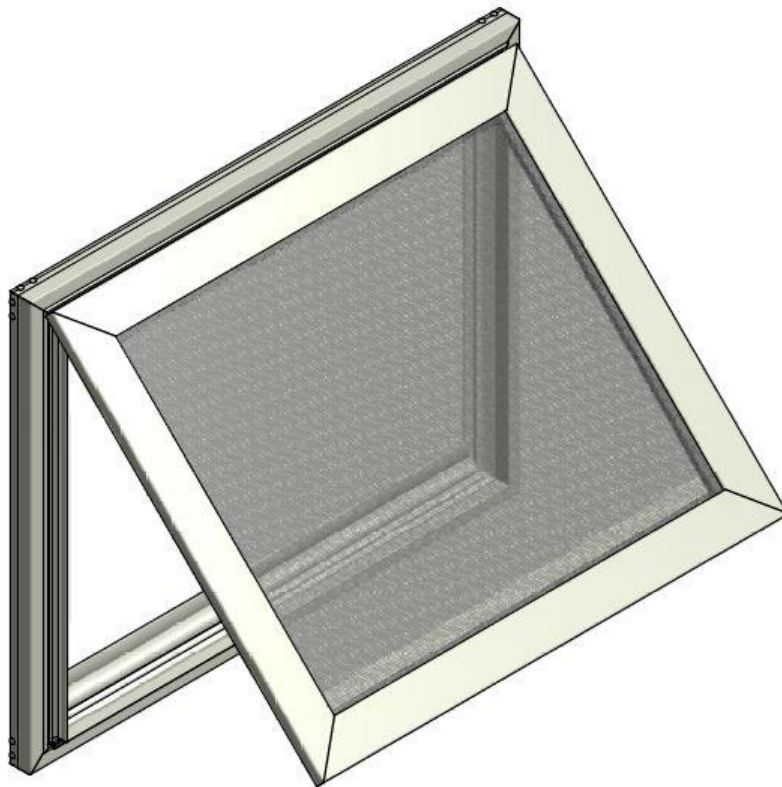

The features of the new and improved Invisi-Scape Outward Opening system are;

#### **NEW HOLLOW PERIMETER FRAME**

- The more robust perimeter frame increases rigidity, reduces sag, has greater impact resistance and improves security
- Inclusion of a screw flute in the perimeter frame for greater strength and ease of fabrication
- Concealed fixings - This not only improves security by putting fixings out of site from attackers, but also improves the exterior appearance and aids cleaning when required
- The same perimeter frame is used for Invisi-Screen and Invisi-Screen Maxx

#### **NEW FLAT FACED SASH**

- Smooth external face giving a more modern & contemporary appearance
- Corner stake inside the sash now doubles the "I Value"
- Reduced frame width increases open mesh area for greater visibility and increased air flow
- A reduction in the clearance between the sash and the perimeter frame to minimise any possibility of a pinch point for fingers
- Bulb seal added to reduce noise when screen is latched closed and also removes noise from any screen movement under extreme weather conditions

#### **NEW SCREEN RELEASE LEVER**

- A "push" to escape handle system - when it is time to exit the new "push" to escape handle lets you unlock and open the screen in one smooth and easy motion
- Handle now releases screen after only 20° of movement aiding in a speedy escape when required

#### **NEW INTERNAL SASH HANDLE**

- Integrated internal sash handle gives consistent clean lines around the internal sash frame.
- Increased rigidity to reduce any flex when closing large screens.

The Tech Manuals in the dealer section of the Invisi website reflect these new sections. The new Invisi-Scape sections are as follows:

Code	Description
1409550	IWF10 PERIMETER FRAME
1409551	IWF11 PERIMETER HINGE FRAME
1409552	IWF12 FRAME INFILL
1409553	IWF13 INVISI-MAXX ESCAPE SASH
1409554	IWF14 INVISI-GARD ESCAPE SASH
1409555	IWF15 ESCAPE HANDLE
1402060	SW6 SECURITY GRILLE ESCAPE SASH

If you have any questions please do not hesitate to contact your Area Manager or Branch.

Regards,  
Product Development Team

